



## About Warnings



**WARNING:** A WARNING indicates a potential for property damage, personal injury, or death.

# Dell™ Vostro™ 1220 Setup and Features Information

## Front View

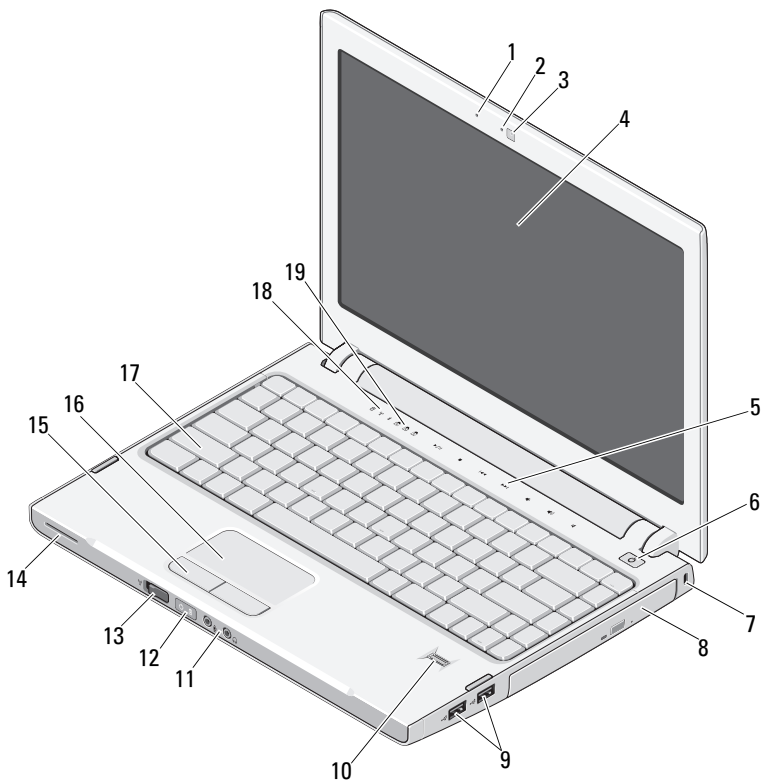

April 2009



OD538PA00

Model: P03S series  
Type: P03S001

- |    |                                                                 |    |                                        |
|----|-----------------------------------------------------------------|----|----------------------------------------|
| 1  | microphone (optional)                                           | 2  | camera light (optional)                |
| 3  | camera (optional)                                               | 4  | display                                |
| 5  | media controls (volume, forward, reverse, stop, play, and mute) | 6  | power button                           |
| 7  | security slot                                                   | 8  | optical device in media bay            |
| 9  | USB connectors (2)                                              | 10 | fingerprint reader (optional)          |
| 11 | audio connectors (2)                                            | 12 | power and battery charge status lights |
| 13 | wireless switch                                                 | 14 | speaker                                |
| 15 | touch pad buttons (2)                                           | 16 | touch pad                              |
| 17 | keyboard                                                        | 18 | device status lights                   |
| 19 | keyboard status lights                                          |    |                                        |

## Back View

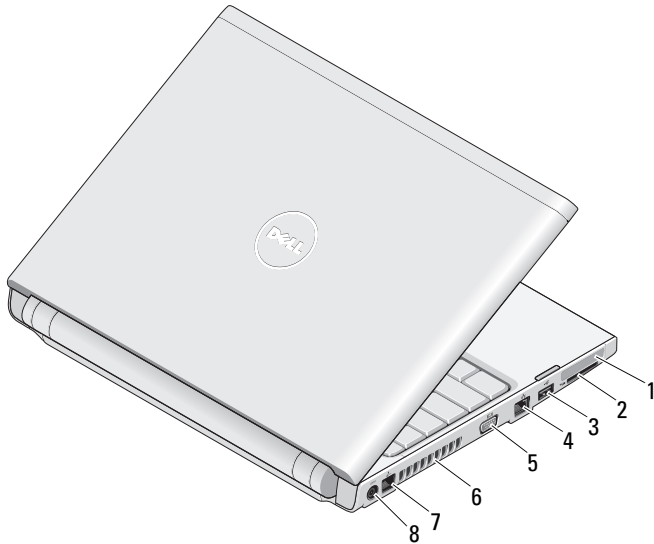

- |   |                  |   |                      |
|---|------------------|---|----------------------|
| 1 | ExpressCard slot | 2 | SD card reader slot  |
| 3 | USB connector    | 4 | network connector    |
| 5 | VGA connector    | 6 | cooling vents        |
| 7 | phone connector  | 8 | AC adapter connector |

## Quick Setup



**WARNING:** Before you begin any of the procedures in this section, read the safety information that shipped with your computer. For additional best practices information, see [www.dell.com/regulatory\\_compliance](http://www.dell.com/regulatory_compliance).



**WARNING:** The AC adapter works with electrical outlets worldwide. However, power connectors and power strips vary among countries. Using an incompatible cable or improperly connecting the cable to the power strip or electrical outlet may cause fire or equipment damage.



**CAUTION:** When you disconnect the AC adapter cable from the computer, grasp the connector, not the cable itself, and pull firmly but gently to avoid damaging the cable. When you wrap the AC adapter cable, ensure that you follow the angle of the connector on the AC adapter to avoid damaging the cable.



**CAUTION:** Your computer ships with a plastic blank installed in the ExpressCard slot and SD card reader slot. Blanks protect unused slots from dust and other particles. Save the blank for use when no ExpressCard or media card is installed in the slot; blanks from other computers may not fit your computer.



**NOTE:** Some devices may not be included if you did not order them.

- 1 Connect the AC adapter to the AC adapter connector on the portable computer and to the electrical outlet.

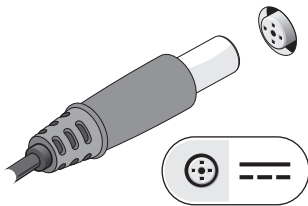

- 2 Connect the network cable (optional).

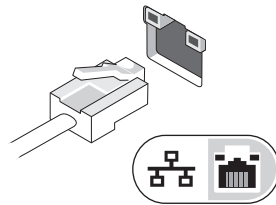

- 3 Connect USB devices, such as a mouse or keyboard (optional).

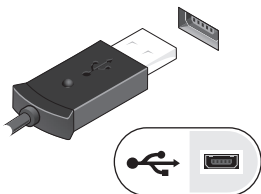

- 4 Open the computer display and press the power button to turn on the computer.

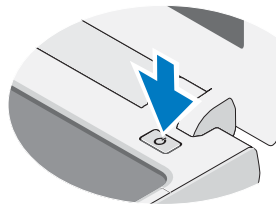

**NOTE:** It is recommended that you turn on and shut down your computer at least once before you install any cards or connect the computer to an external device, such as a printer.

## Specifications



**NOTE:** Offerings may vary by region. The following specifications are only those required by law to ship with your computer. For more information regarding the configuration of your computer, click **Start**→**Help and Support** and select the option to view information about your computer.

---

### System Information

---

Chipset	Intel® GM45
---------	-------------

---

### Processor

---

Processors	Intel Celeron®, Intel Celeron Dual Core, or Intel Core™ 2 Duo
------------	---------------------------------------------------------------

---

### Video

---

Video type	integrated on system board
Data bus	integrated video
Video controller	Intel Extreme Graphics
Video memory	up to 256 MB (shared)

---

### Memory

---

Memory module connector	2 DIMM slots
Memory module capacity	1 GB, 2 GB, or 4 GB
Memory type	DDR2 800 MHz
Minimum memory	1 GB
Maximum memory	8 GB

---

### Battery

---

Type	4-cell and 6-cell
------	-------------------

Dimensions:

Depth

4-cell	46.50 mm (1.83 inches)
--------	------------------------

6-cell	46.50 mm (1.83 inches)
--------	------------------------

Height

4-cell	35.85 mm (1.41 inches)
--------	------------------------

6-cell	40.64 mm (1.60 inches)
--------	------------------------

---

**Battery (continued)**

---

Voltage	
4-cell	12 V (minimum), 17.7 V (maximum)
6-cell	9 V (minimum), 13.3 V (maximum)
Temperature range:	
Operating	0° to 50°C (32° to 122°F)
Storage	-20° to 65°C (4° to 149°F)
Coin-cell battery	CR2032

---

**AC Adapter**

---

Type	65 W
Input voltage	100–240 VAC
Input current (maximum)	1.5 A
Input frequency	50–60 Hz
Output current:	
65 W	4.34 A (maximum at 4 seconds pulse), 3.34 A (continuous)
Rated output voltage	19.5 VDC
Temperature range:	
Operating	0° to 40°C (32° to 104°F)
Storage	-40° to 70°C (-40° to 158°F)

---

**Physical**

---

Height:	
with a CCFL panel	23.5–37.6 mm (0.93–1.48 inches)
with a WLED panel	23.5–36.6 mm (0.93–1.44 inches)
Width	294.0 mm (11.57 inches)
Depth	228.7 mm (9.00 inches)
Weight:	
with a 4-cell battery, 128 GB SSD, WLED panel, and no optical drive	1.52 kg (3.36 lbs)

---

**Environmental**

---

Temperature range:

Operating	0° to 35°C (32° to 95°F)
Storage	-40° to 65°C (-40° to 149°F)

Relative humidity (maximum):

Operating	10% to 90% (noncondensing)
Storage	5% to 95% (noncondensing)

## Finding More Information and Resources

---

**If you need to:****See:**

Find safety best practices information for your computer, review Warranty information, Terms and Conditions(U.S only), Safety instructions, Regulatory information, Ergonomics information, and End User License Agreement.

The safety and regulatory documents that shipped with your computer and the Regulatory Compliance Homepage at [www.dell.com/regulatory\\_compliance](http://www.dell.com/regulatory_compliance).

---

---

**Information in this document is subject to change without notice.**

**© 2009 Dell Inc. All rights reserved. Printed in China. Printed on recycled paper.**

Reproduction of these materials in any manner whatsoever without the written permission of Dell Inc. is strictly forbidden.

Trademarks used in this text: *Dell*, the *DELL* logo, and *Vostro* are trademarks of Dell Inc.; *Intel* and *Celeron* are registered trademarks and *Core* is a trademark of Intel Corporation in the U.S. and other countries.

Other trademarks and trade names may be used in this document to refer to either the entities claiming the marks and names or their products. Dell Inc. disclaims any proprietary interest in trademarks and trade names other than its own.